

KEYING LEGEND

KA # = "Keyed Alike" to other doors matching the same # designation. One key will open all of the same designation.

KD # = "Keyed Different" (not matching any other door) but has an overriding "Area Master" designated by the # (A, B, etc)

CARD ACCESS DOOR

Keys are not issued for these doors. Must request card access with the corresponding # inside the symbol.

 -CARD READER
Card swipe for entry

 -STRIKE ONLY
No Card swipe entry
On schedule only

 -MONITORED ONLY
Exit only
Door typically locked
No Card swipe entry
No schedule

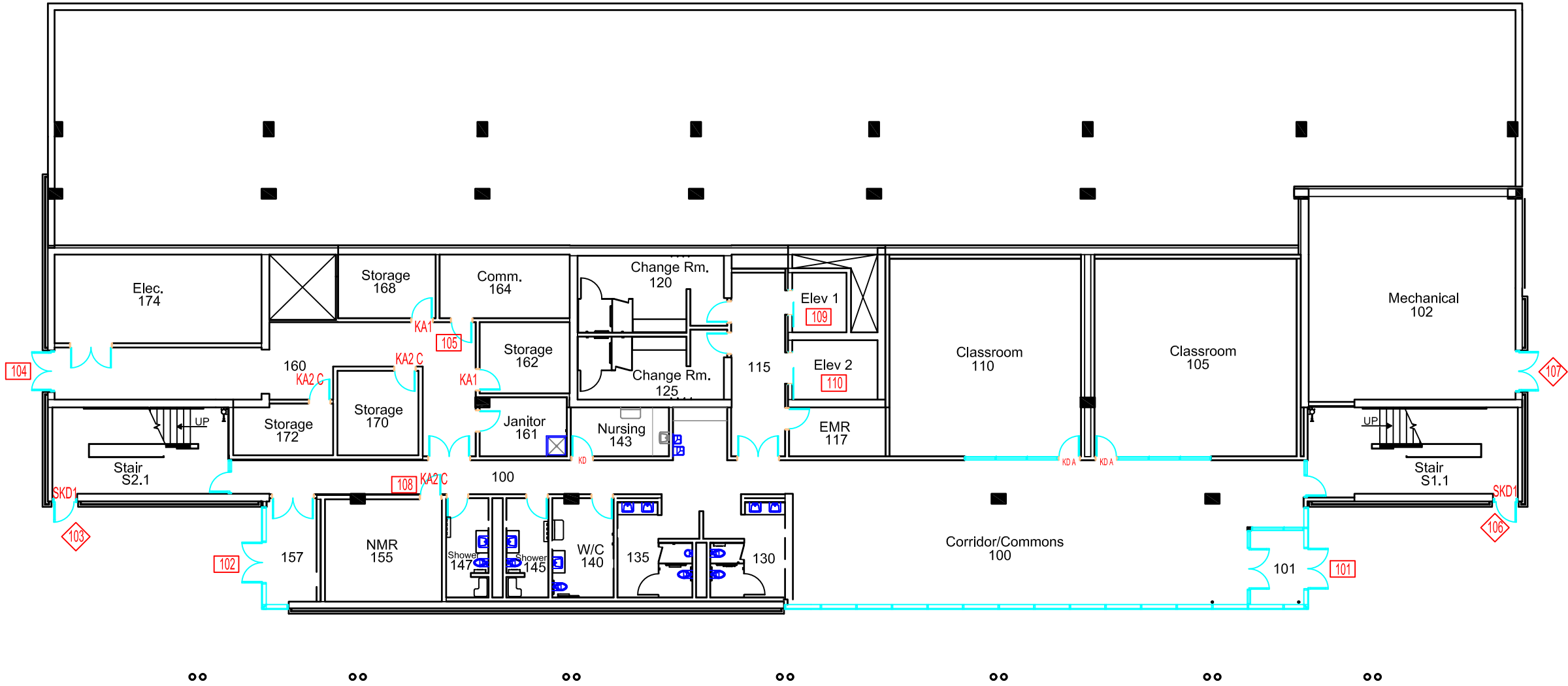

BUILDING NAME AND NUMBER
**HEALTH AND SCIENCE
CENTRE
BLDG 210**

FLOOR
FIRST FLOOR

DRAWING NAME
BASE PLAN

REVISION DATE
JULY 2017

SCALE: **1:200** PAGE NUMBER: **210.1**