

KEYING LEGEND

KA # = "Keyed Alike" to other doors matching the same # designation. One key will open all of the same designation. This door is also on the designated area master indicated with A, B, etc following the number.

KD # = "Keyed Different" (not matching any other door) but has an overriding "Area Master" designated by the # (A, B, etc)

CARD ACCESS DOOR

Keys are not issued for these doors. Must request card access with the corresponding # inside the symbol.

-CARD READER
Card swipe for entry

△ -STRIKE ONLY
No Card swipe entry
On schedule only

◇ -MONITORED ONLY
Exit only
Door typically locked
No Card swipe entry
No schedule

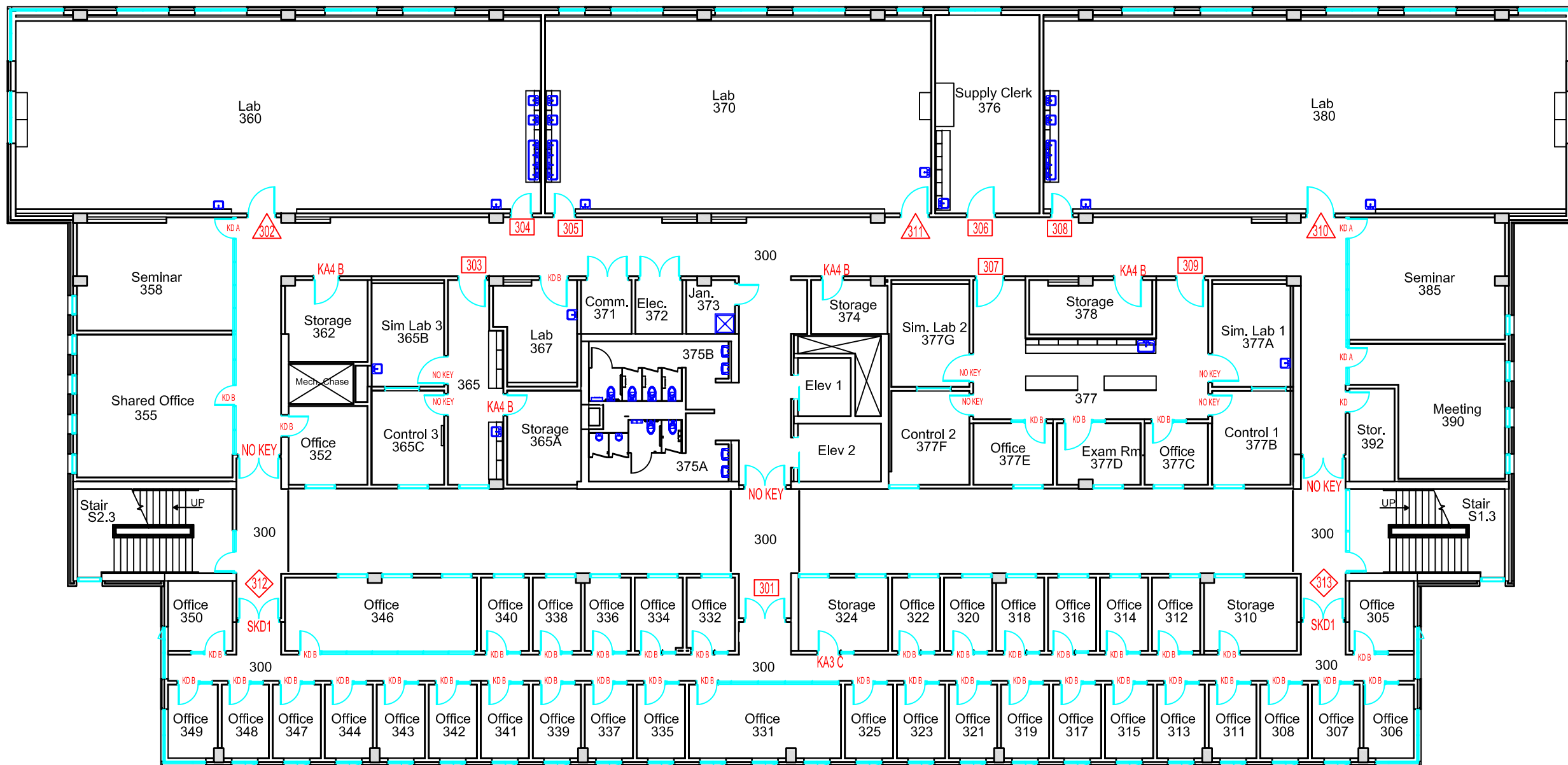

BUILDING NAME AND NUMBER
HEALTH AND SCIENCE CENTRE BLDG 210

FLOOR
THIRD FLOOR

DRAWING NAME
BASE PLAN

REVISION DATE
JULY 2017

SCALE
1:200

PAGE NUMBER
210.3