

KEYING LEGEND

KA # = "Keyed Alike" to other doors matching the same # designation. One key will open all of the same designation. This door is also on the designated area master indicated with A, B, etc following the number.

KD # = "Keyed Different" (not matching any other door) but has an overriding "Area Master" designated by the # (A, B, etc)

CARD ACCESS DOOR

Keys are not issued for these doors. Must request card access with the corresponding # inside the symbol.

-CARD READER
Card swipe for entry

⚠ -STRIKE ONLY
No Card swipe entry
On schedule only

⚡ -MONITORED ONLY
Exit only
Door typically locked
No Card swipe entry
No schedule

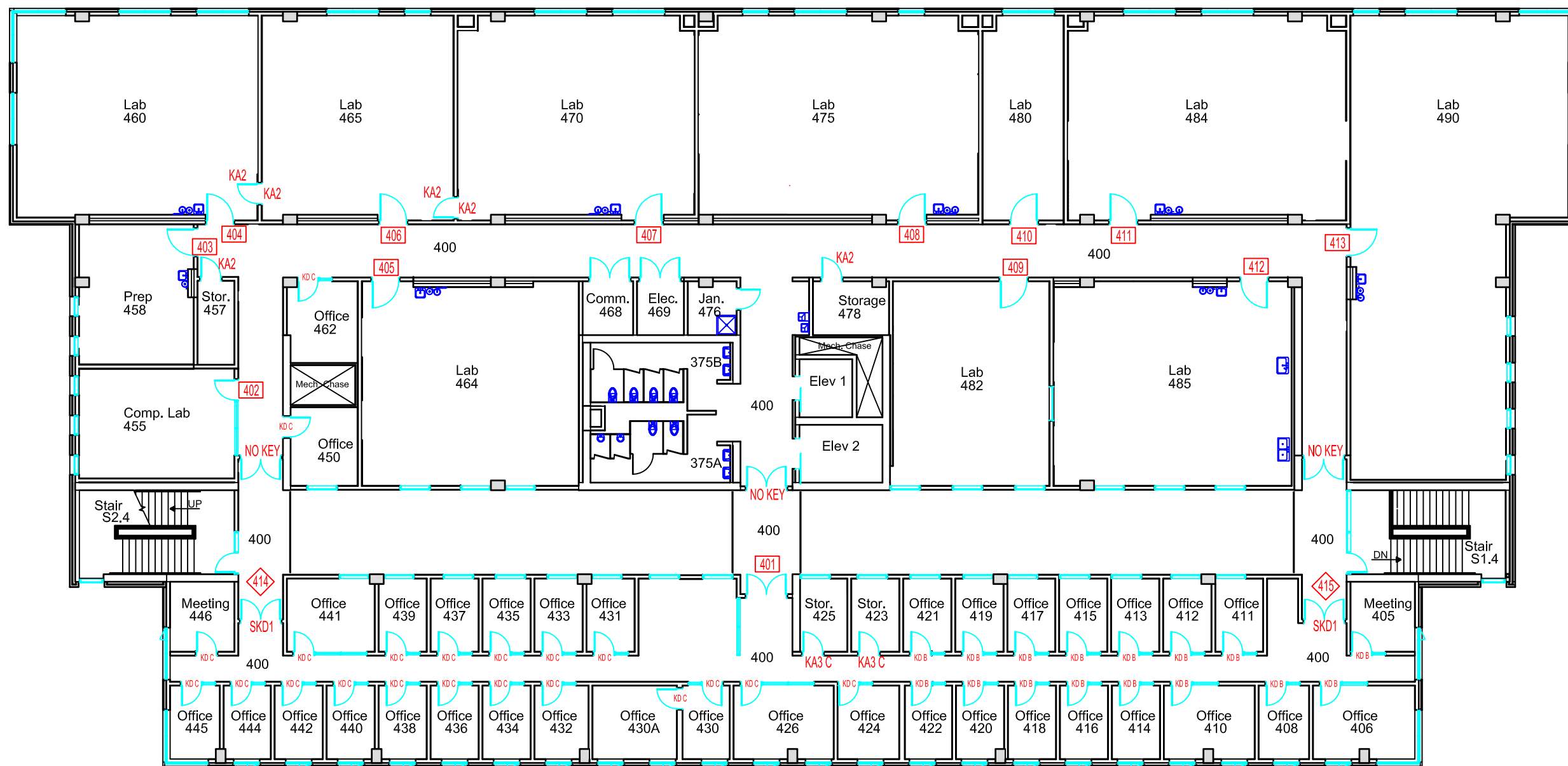
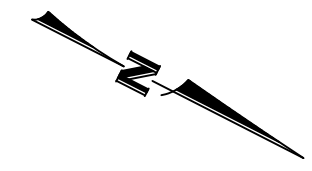

BUILDING NAME AND NUMBER
**HEALTH AND SCIENCE
CENTRE
BLDG 210**

FLOOR
FOURTH FLOOR

DRAWING NAME
BASE PLAN

REVISION DATE
JULY 2017

SCALE
1:200

PAGE NUMBER
210.4